

USG Ensemble™ Acoustical Drywall Ceiling

Offers the Seamless Look of Drywall
with the Acoustical Properties of
a Traditional Tile-and-Grid Ceiling.

usg.com/ensemble

Ideal for high-end applications, including lobbies, atriums, executive/board rooms, museums—or other spaces with multiple hard surfaces.

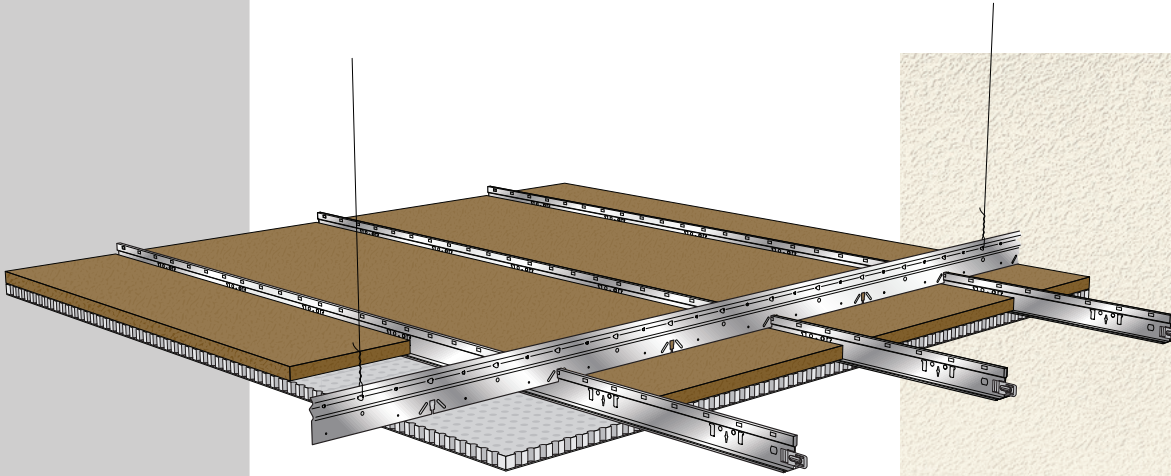

USG Ensemble™ Acoustical Drywall Ceiling

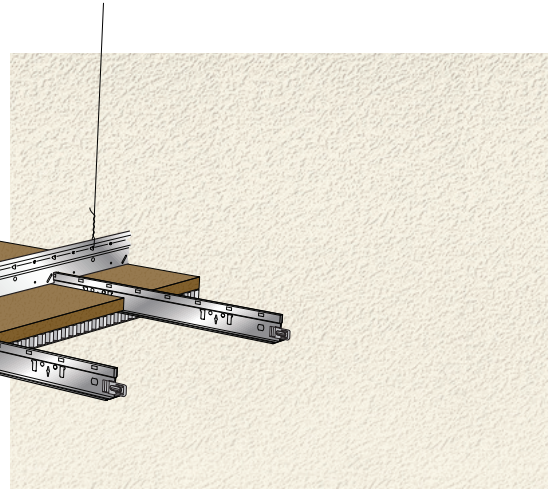

USG Ensemble™ Spray-Applied Finish

Form and Function

Today, building owners and occupants desire high-performing acoustical solutions with clean, elegant finishes. The ceiling is a critical surface that can manage the acoustical performance and enhance the overall aesthetic.

USG has created a new integrated system that offers the uninterrupted look of drywall with the high-performance acoustics of traditional lay-in ceiling panels.

Key Features Include:

- NRC 0.80 and CAC 44
- LR .85, from the spray-applied fine finish
- Class A rated
- Low VOC-emitting material
- Meets or exceeds minimum ceiling performance requirements for traditional acoustical ceilings

Installation

The system is constructed using methods similar to conventional drywall installation and finishing techniques.

How It Works

USG Sheetrock® Brand Ensemble™ Panels are highly engineered to perform like acoustical ceiling panels. The panels are screw-attached to a modified drywall suspension system. The joints are finished using USG Sheetrock® Brand Ensemble™ Ceiling Compound and USG Ensemble™ Spray-Applied Finish is installed as the final surface. The Spray-Applied Finish is acoustically transparent and allows sound to pass through the perforations where it is absorbed by the USG Ensemble™ High-NRC Backer Panels and plenum space. All system components are designed to work together so that NRC and CAC performance is maximized.

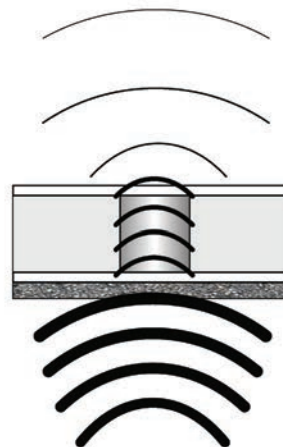

*NRC 0.80
and CAC 44*